

Client: S&S Coates Surveying & Design
 Project: Proposed Replacement Dwelling at The Boat Shop, Mentmore Road, Leighton Buzzard, LU7 2AE
 Date: 04/08/2020
 Scale: As stated

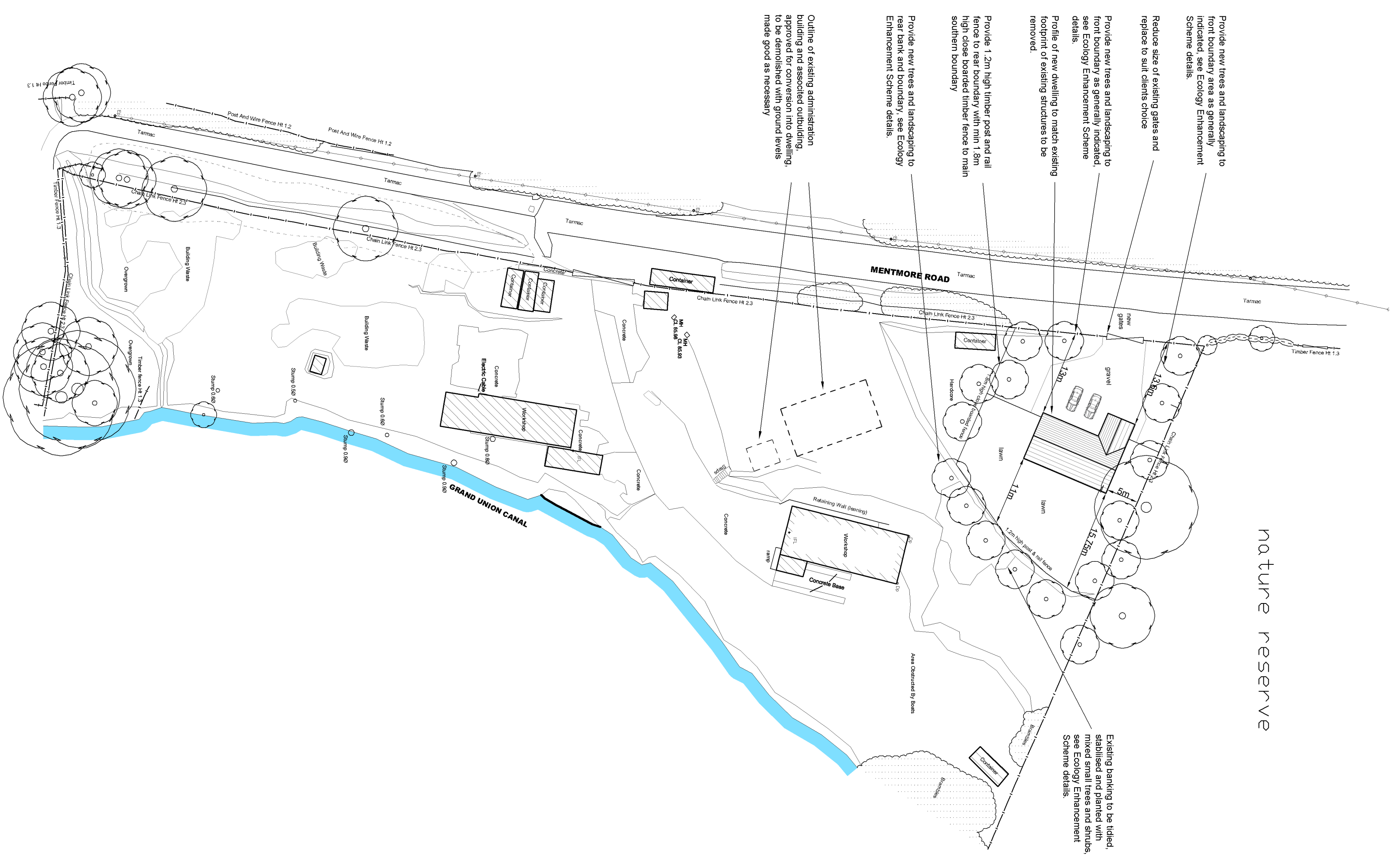

SITE LOCATION PLAN
 Scale 1:1250



nature reserve

Provide new trees and landscaping to front boundary area as generally indicated on Ecology Enhancement Scheme details.

Reduce size of existing gaps and replace to suit climate choice

Provide new trees and landscaping to rear boundary area as generally indicated on Ecology Enhancement Scheme details.

Profile of new dwelling to match existing footprint of existing structures to be removed

Provide 1.2m high timber post and rail fence to rear boundary with 1.5m high privacy fence to main southern boundary

Provide new trees and landscaping to rear bank and boundary, see Ecology Enhancement Scheme details.

Existing building to be lifted, stabilised and painted with mixed small trees and shrubs, see Ecology Enhancement Scheme details.

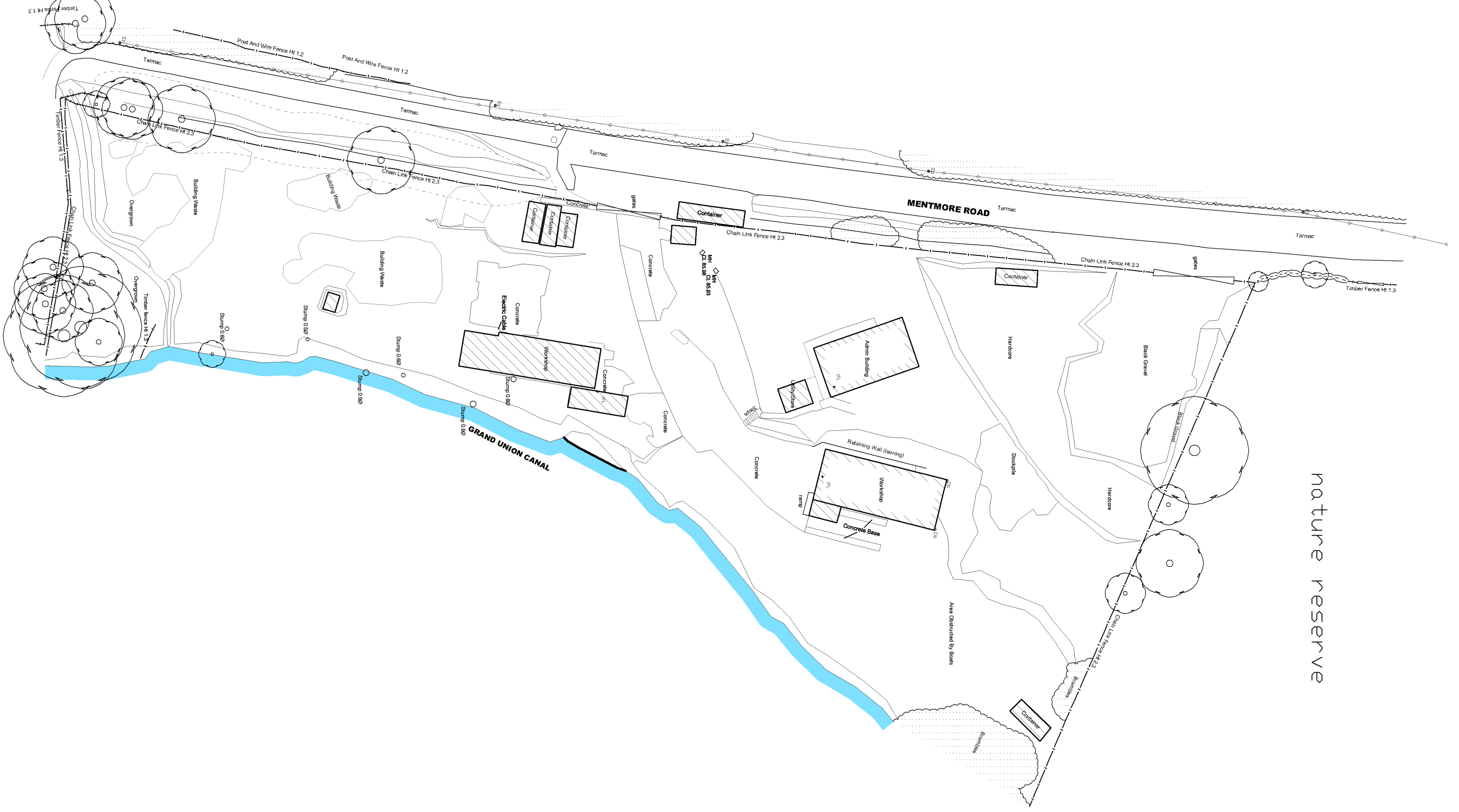

nature reserve

EXISTING BLOCK PLAN
 Scale 1:500

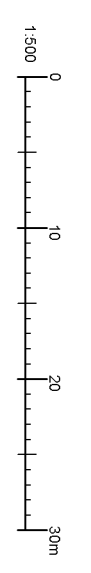

PROPOSED BLOCK PLAN
 Scale 1:500

<p>REVISIONS</p>			
<p>Project: Proposed Replacement Dwelling at The Boat Shop, Mentmore Road, Leighton Buzzard, LU7 2AE</p>			
<p>Title: Existing and Proposed Block Plans and Site Location plan</p>			
Scale:	Date:	Drawn:	
As stated	04/08/2020	SJC	
Job No.:	SC/2005830		
Drawing No.:	02	Rev.:	
<p>S & S Coates Surveying & Design Room 2, Denel Wing, The Rufus Centre, Steppingley Road, Filwick, MK45 1AH Tel.: 01525 862457 or 07960 215053 stevecoates72@gmail.com</p>			

